

Benton Junior College



Our Mission:

*To motivate to learn; to teach to think; to encourage to imagine;
and to show the compassion to care globally*

03/02/2009

Newsletter

Welcome Back to Benton:

A warm welcome to our new and returning families. We were very fortunate not to have returned last week, in the midst of the terrible heat. Children and staff have settled well and are happy establishing negotiated class rules and exploring the new routines.

An enormous amount was achieved over the break with the second water tank installed and galleries built between the relocatable classrooms for Years 2 and 4. We hope this wonderful space will soon be finished and an enormous thank you to Justin Kestles, Tom Peters and John McDonald - who worked through the shocking heat to make the areas safe for our return. Appreciation also to Marcus Batt whose work with planners, Council, etc. was invaluable. Well done!

Welcome to our new staff including Kate Kiernan, Susan Bernhard, Adele Hobson, Robyn Mayle, Paul Seaman, Monica O'Dea, Rebecca Clarke, Fran Atherton and Carole Richardson.

2009 College Map

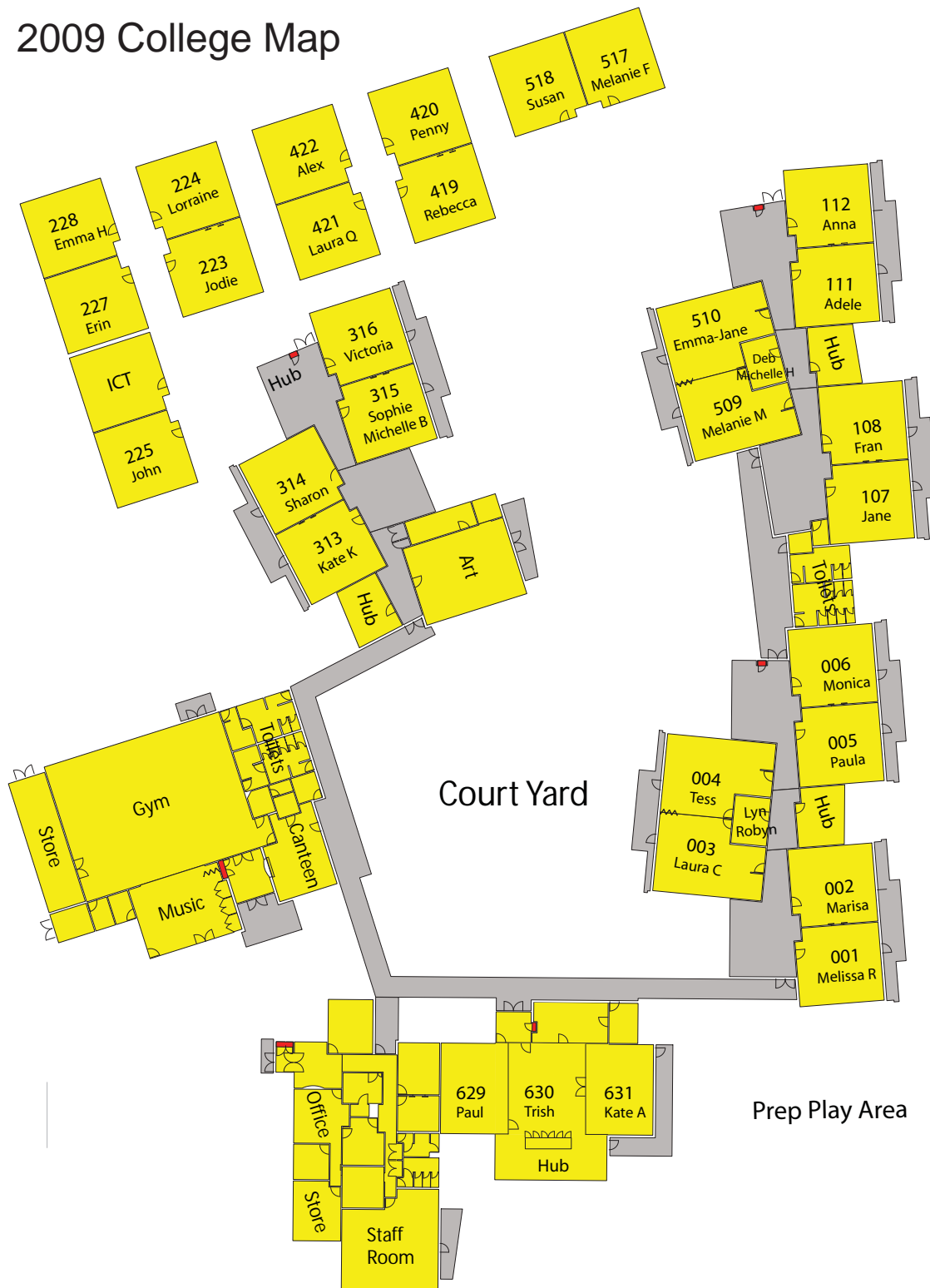

School Zone Speed Limits

Motorists are reminded to take their time and remain vigilant as the 40 kilometres per hour zones around schools come back into force. All school aged children will return to their classrooms across Victoria this week and drivers need to be more tolerant when driving near schools.

Ladies Netball

The Benton Netball Club has entered two teams in the Wednesday night ladies netball competition. Games are indoors at the Dunns Road Stadium and begin Wednesday 11 February. Registration is \$60.00. If you are interested in playing, please come to training at the College at 10:00am Saturday 7 February or ring Jeff O'Donnell on 5974 2854.

Personal Items Brought To College

Personal property is sometimes brought to the college by children, staff and visitors. This can include mobile phones, calculators, toys and sporting equipment. The Department of Education and Early Childhood Development does not hold insurance nor does it accept responsibility for private property brought by children, staff and visitors. Parents and children are reminded not to bring any particularly valuable items to College.

Music Tuition

Instrumental music lessons will commence Wednesday 4 February. Prep, Years 1 and 2 lessons are available in keyboard and drums. Years 3 to 6 children can learn to play: keyboard, drums, guitar, flute, saxophone, trumpet and clarinet. As the majority of our college instruments are already allocated, children who have their own instrument will be most welcome to join the sessions. Lessons are held during college hours in groups of two at a cost of \$15 per session, paid a term in advance. Please contact the College Office if you wish to enrol your child in the instrumental music program. All payment must be made to the instrumental music teacher.

School Injuries and Insurance

Parents and guardians are generally responsible for paying the cost of medical treatment for injured children, including any transport costs, unless the injury is caused by the negligence of a Department or College Council employee or volunteer. Most medical costs will be refundable by Medicare. If you are a member of an ambulance or health insurance fund, you may also be able to claim transport or other expenses from the fund.

The Department of Education and Early Childhood Development does not hold accident insurance for children.

Is other insurance cover available?

Yes.

Student accident insurance policies are available from the private insurance market. These cover a range of medical expenses not covered by Medicare. Parents must consider the cost of the policy taking into account the nature of the policy. DEECT is aware of two insurers, JUA Underwriting Agency Pty Ltd (dpurcell@juaunderwriting.com.au) and EBM Insurance Brokers Pty Ltd (www.studentcover.com.au) that provide individual accident insurance policies for children. Other insurers may also do so. It is not compulsory for schools to purchase 'whole of school' policies and as families have differing needs, Benton College Council advises parents that this is a parent responsibility.

Principal Team:

irving.cheryl.cc@edumail.vic.gov.au
batt.marcus.j@edumail.vic.gov.au
foster.lynette.f@edumail.vic.gov.au
morris.marc.d@edumail.vic.gov.au
College Council President:
dave.zovak@crmladers.org

Benton children are members of a global community, connected to the whole world by ties of cultures, economics, politics and shared environmental concerns.

Benton Junior College is internationally accredited in association with:



Achieving the highest standards in International Education.



Developing inquiring, knowledgeable and caring young people.

Term Dates

Wednesday 4 February
Prep Assessment begins.
No Preps attend

Tuesday 10 February
Subway orders to College

Wednesday 11 February
Subway lunch orders delivered
Safety House Mtg. 7.30pm

Friday 13 February
Book Club due

Tuesday 17 February
College Council Mtg. 5.00pm

Monday 9 March
Labour Day

Tues 10 - Frid 13 March
Yrs 5/6 Water Safety Program

Wednesday 18 March
College Photographs

Friday 3 April
End of Term One
2.15pm Dismissal

Monday 20 April
Term Two Commences



2009 Staff Team



Principal Team
Cheryl Irving



Marcus Batt



Marc Morris



Lyn Foster



Melissa Roser
001



Marisa Jones
002



Tess Sly
003



Laura Campbell
004



Paula Tuck
005



Monica O'Dea
006



Liz Weller
Business Manager



Jane Rhall
107



Fran Atherton
108



Adele Hobson
111



Anna Vevers
112



Michele Marshall
Art



Lyn Marchetti
Office



Jodie Brasher
223



Lorraine Hart
224



John Walkington
225



Erin Buckingham
227



Emma Hannan
228



Jabyng Hogarth
Physical Education



Carole Richardson
Office



Sharon Briggs
313



Kate Kiernan
314



Sophie Hogarth
315



Michelle Bremner
315



Victoria Aoki
316



Lloyd Poole
Music



Jenny Nunn
Integration Aide



Penny Malcomson
419



Rebecca Clarke
420



Laura Quigley
421



Alex Petrovic
422



Grant Gains
ICT



Debbie Bugeja
Integration Aide



Melanie Minos
509



Emma Williams
510



Melanie French
517



Susan Bernhard
518



Michelle Hobbs
LOTE



Yuri Taniguchi
LOTE Assistant



Karen Irving
Resource Tech



Paul Seaman
629



Trish Wallace
630



Kate Alston
631



Robyn Mayle
Resource Skills